

## Copper Lug, AWG 350KCM#, two hole 1/2", hole spacing 1", long barrel, with inspection window,red

- Copper cable lugs are designed for connecting copper cables, coils and Bus-bars
- Copper Tube Terminals between 6mm<sup>2</sup> & 800mm<sup>2</sup> have bell entry to ensure easy entry even for flexible conductors.
- Incorporates inspection window to check the correct cable positioning.
- The barrel length has been designed to allow easy and accurate positioning of the dies during the crimping operation.
- "colour code" help choose the right connector, the colour name is also printed in order to avoid problems for those who are colour-blind.



### Product Classification

Item Number	6008451
Part Number	-
Detail Description	Copper Lug, AWG 350KCM#, two hole 1/2", hole spacing 1", long barrel, with inspection window,red

### General Specifications

Colour Code	Red
Material	Copper
Tongue Type	Standard
Tongue Angle	Straight
Surface	Tin-plated
Inspection Window	With inspection window

### Dimensions

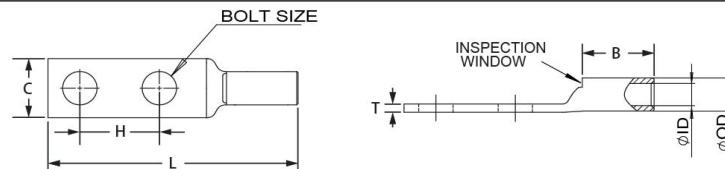

Bolt Size	0.51 in   13.0 mm
Hole Spacing (H)	1.00 in   25.4 mm
Tang Width (C)	1.28 in   32.5 mm
Barrel length (B)	2.00 in   50.8 mm
Overall length (L)	4.87 in   123.8 mm

For more information, please visit:  
[www.maxdao.com](http://www.maxdao.com)



©Maxdao Inc. All rights reserved.

The information contained herein is subject to change without notice. We reserve the right to make technical changes or modify the contents of this document without prior notice.

Revised: Aug 30, 2024  
 Public

Inner diameter (ID) 0.72 in | 18.2 mm

Outer diameter(OD) 0.89 in | 22.5 mm

---

**Electrical Specifications**

---

Rating - Maximum Voltage 35KV

---

**Environmental Specifications**

---

Operating Temperature -40 °C to +90°C (-40 °F to +212 °F)

Storage Temperature -40 °C to +80 °C (-40 °F to +176 °F)

---

**Packaging and Weights**

---

Included Lug

Packaging Quantity and UOM 1 pcs

Piece Weight 0.33 lb | 0.15 kg

---

**Certifications and Compliance**

---

ISO 9001:2015 Designed, manufactured and/or distributed under this quality management system

RoHS Compliant

UL Compliant

