

Copper Lug, AWG 8#, two hole 10#, hole spacing 5/8", long barrel, with inspection window

- Copper cable lugs are designed for connecting copper cables, coils and Bus-bars
- Copper Tube Terminals between 6mm² & 800mm² have bell entry to ensure easy entry even for flexible conductors.
- Incorporates inspection window to check the correct cable positioning
- Long barrel provides high pull-out force and increased retention for improved mechanical and electrical performance.



Product Classification

Item Number	6003901
Part Number	-
Detail Description	Copper Lug, AWG 8#, two hole 10#, hole spacing 5/8", long barrel, with inspection window

General Specifications

Material	Copper
Tongue Type	Standard
Tongue Angle	Straight
Surface	Tin-plated
Inspection Window	With inspection window

Dimensions

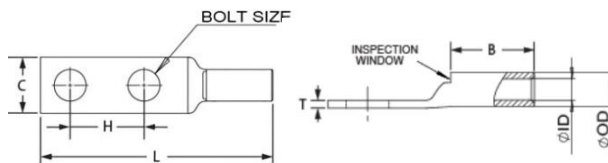

Bolt Size	0.20 in 5.0 mm
Hole Spacing (H)	5/8 in 16.0 mm
Tang Width (C)	0.44 in 12.2 mm
Barrel length (B)	1.00 in 25.4 mm
Overall length (L)	2.46 in 62.5 mm
Inner diameter (ID)	0.18 in 4.6 mm
Outer diameter (OD)	0.27 in 6.9 mm

Electrical Specifications

Rating - Maximum Voltage	35KV
--------------------------	------

Environmental Specifications

Operating Temperature	-40 °C to +90°C (-40 °F to +212 °F)
Storage Temperature	-40 °C to +80 °C (-40 °F to +176 °F)

Packaging and Weights

Included	Lug
Packaging Quantity and UOM	1 pcs
Piece Weight	0.024 lb 0.011 kg

Certifications

ISO 9001:2015	Designed, manufactured and/or distributed under this quality management system
RoHS	Compliant
UL	Compliant

