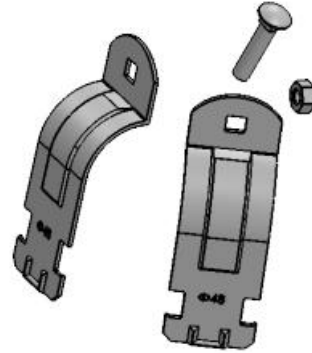

Pipe And Conduit Clamp,for ϕ 27mm pipe and conduit,fixed on B22 channel

- Excellent for outdoor use & indoor use
- Quick and easy assembly
- Vibration proof

**Product Classification**

| | |
|--------------------|---|
| Material Number | 6004667 |
| Part Number | - |
| Status | Active |
| Detail description | Pipe and conduit clamp,for ϕ 27mm pipe and conduit,fixed on B22 channel,2 pc half clamps and 1 pcs M6 \times 25mm carriage bolt and 1 pcs M6 hexagonal nut |

General Specifications

| | |
|-------------------|------------------------------|
| Material | Carbon steel |
| Applied pole size | ϕ 27mm pipe and conduit |
| Color | Silver |
| Surface treatment | Electrogalvanizing |

Dimensions

| | |
|----------------|-------------------|
| Width of clamp | 32 mm 1.26 in |
| Thickness | 1.5 mm 0.059 in |
| Height | 67 mm 2.64 in |
| Screw size | M6 \times 25mm |

Environmental Specifications

| | |
|-----------------------|----------------------------------|
| Operating temperature | -40°C to +85°C (-40°F to +185°F) |
|-----------------------|----------------------------------|

Packaging and Weights

| | |
|----------------------------|-------------------------------|
| Bag width | 200 mm 7.87 in |
| Bag length | 320 mm 12.6 in |
| Included | Half clamps&carriage bolt&nut |
| Packaging quantity and UOM | 1 pcs |
| Weight gross | 0.077 kg 0.17 lb |

Certifications and Compliance

ISO 9001:2015

Designed, manufactured and/or distributed under this quality management system

ROHS

Compliant

