

## Feeder Cable Clamp, for 1/2" Superflexible Cable, 1 way

- Easy and quick installation
- Robust design & material for outdoor use
- Operation Temperature -40~85 °C
- Suitable for cable type 1/2 in Superflexible

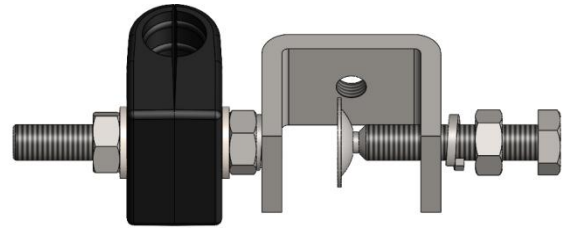

### Product Classification

Material Code	6002848
Part Number	-
Status	Active
Detail Description	Feeder cable clamp,for 1/2" Superflexible cable,1 way, includes hardware and angle adapter

### General Specifications

Material Parts	Stainless +PP
Mounting	M8 hardware
Cables per hanger	1
Color	Black

### Dimensions

Height	36 mm   1.42 in
Width	36 mm   1.42 in
Length	135 mm   5.31 in
Compatible cable OD, maximum	13mm   0.51 in
Compatible cable OD, minimum	14 mm   0.55in

### Environmental Specifications

Salt spray test for metal parts	≥48 Hours,base on ISO 9227: 2017
Operating temperature	-40°C ~ 85°C

### Packaging and Weights

Height, packed	205 mm   8.1 in
Width, packed	325 mm   12.8 in
Length, packed	495 mm   19.4 in
Packaging Quantity and UOM	1 pcs

Weight, gross

0.156 kg | 0.35 lb

---

**Certifications and Compliance**

ISO 9001:2015

Designed, manufactured and/or distributed under this quality management system

ROHS

Compliant

