

Copper Lug, AWG 8#, two hole 1/4", hole spacing 5/8", standard barrel, with inspection window

- Copper cable lugs are designed for connecting copper cables, coils and Bus-bars
- Copper Tube Terminals between 6mm² & 800mm² have bell entry to ensure easy entry even for flexible conductors.
- Incorporates inspection window to check the correct cable positioning
- The barrel length has been designed to allow easy and accurate positioning of the dies during the crimping operation.
- "colour code" help choose the right connector, the colour name is also printed in order to avoid problems for those who are colour-blind.



Product Classification

| | |
|--------------------|---|
| Material Code | 6003909 |
| Part Number | - |
| Detail Description | Copper Lug, AWG 8#, two hole 1/4", hole spacing 5/8", standard barrel, with inspection window |

General Specifications

| | |
|-------------------|------------------------|
| Colour Code | Red |
| Material | Copper |
| Tongue Type | Standard |
| Tongue Angle | Straight |
| Surface | Tin-plated |
| Inspection Window | With inspection window |

Dimensions

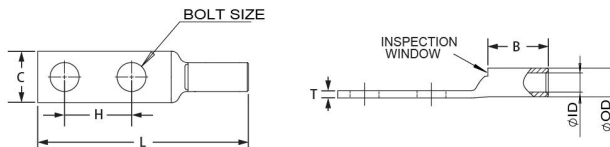

| | |
|---------------------|-------------------|
| Bolt Size | 1/4 in 6.9 mm |
| Hole Spacing (H) | 5/8 in 16.0 mm |
| Tang Width (C) | 0.44 in 11.2 mm |
| Barrel length (B) | 0.44 in 11.2 mm |
| Overall length (L) | 1.95 in 50.4 mm |
| Inner diameter (ID) | 0.18 in 4.6 mm |
| Outer diameter (OD) | 0.27 in 6.9 mm |



Electrical Specifications

| | |
|--------------------------|------|
| Rating - Maximum Voltage | 35KV |
|--------------------------|------|

Environmental Specifications

| | |
|-----------------------|-------------------------------------|
| Operating Temperature | -40 °C to +90°C (-40 °F to +212 °F) |
|-----------------------|-------------------------------------|

| | |
|---------------------|--------------------------------------|
| Storage Temperature | -40 °C to +80 °C (-40 °F to +176 °F) |
|---------------------|--------------------------------------|

Packaging and Weights

| | |
|----------|-----|
| Included | Lug |
|----------|-----|

| | |
|----------------------------|-------|
| Packaging Quantity and UOM | 1 pcs |
|----------------------------|-------|

| | |
|--------------|---------------------|
| Piece Weight | 0.024 lb 0.011 kg |
|--------------|---------------------|

Certifications

| | |
|---------------|--|
| ISO 9001:2015 | Designed, manufactured and/or distributed under this quality management system |
|---------------|--|

| | |
|------|-----------|
| RoHS | Compliant |
|------|-----------|

| | |
|--------|-----------|
| UL&CSA | Compliant |
|--------|-----------|

