

Copper Lug, AWG 8#, two hole 10#, hole spacing 5/8", standard barrel, with inspection window

- Copper cable lugs are designed for connecting copper cables, coils and Bus-bars.
- Copper Tube Terminals between 6mm² & 800mm² have bell entry to ensure easy entry even for flexible conductors.
- Incorporates inspection window to check the correct cable positioning.
- "colour code" help choose the right connector, the colour name is also printed in order to avoid problems for those who are colour-blind.



Product Classification

| | |
|--------------------|---|
| Material Code | 6006629 |
| Part Number | - |
| Detail Description | Copper Lug, AWG 8#, two hole 1/4", hole spacing 5/8", standard barrel, with inspection window |

General Specifications

| | |
|-------------------|------------------------|
| Colour Code | Red |
| Material | Copper |
| Tongue Type | Standard |
| Tongue Angle | Straight |
| Surface | Tin-plated |
| Inspection Window | With inspection window |

Dimensions

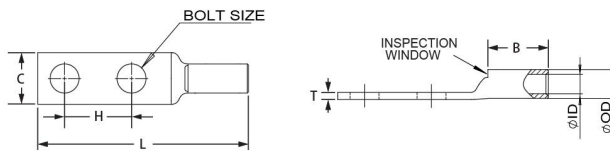

| | |
|---------------------|-------------------|
| Bolt Size | 0.20 in 5.2 mm |
| Hole Spacing (H) | 5/8 in 16.0 mm |
| Tang Width (C) | 0.44 in 11.2 mm |
| Barrel length (B) | 0.44 in 11.2 mm |
| Overall length (L) | 1.85 in 47.8 mm |
| Inner diameter (ID) | 0.18 in 4.6 mm |
| Outer diameter (OD) | 0.27 in 6.9 mm |

Electrical Specifications

| | |
|--------------------------|------|
| Rating - Maximum Voltage | 35KV |
|--------------------------|------|

For more information, please visit:
www.maxdao.com



©Copyright 2023 Maxdao Inc. All rights reserved.

The information contained herein is subject to change without notice. We reserve the right to make technical changes or modify the contents of this document without prior notice.

Revised: Mar 08, 2023

Public

Environmental Specifications

| | |
|-----------------------|--------------------------------------|
| Operating Temperature | -40 °C to +90°C (-40 °F to +212 °F) |
| Storage Temperature | -40 °C to +80 °C (-40 °F to +176 °F) |

Packaging and Weights

| | |
|----------------------------|---------------------|
| Included | Lug |
| Packaging Quantity and UOM | 1 pcs |
| Piece Weight | 0.024 lb 0.011 kg |

Certifications

| | |
|---------------|--|
| ISO 9001:2015 | Designed, manufactured and/or distributed under this quality management system |
| RoHS | Compliant |
| UL&CSA | Compliant |

