

Copper Lug, AWG 6#, two hole 3/8", hole spacing 3/4"-1", long barrel, without inspection window

- Copper cable lugs are designed for connecting copper cables, coils and Bus-bars
- Copper Tube Terminals between 6mm² & 800mm² have bell entry to ensure easy entry even for flexible conductors.
- The absence without inspection window prevents the entry of water or moisture into the crimped joint making these terminals suitable for outdoor applications.
- "colour code" help choose the right connector, the colour name is also printed in order to avoid problems for those who are colour-blind.
- A hole with elliptical design is suitable for more spacing.



Product Classification

Material Code	6003721
Part Number	-
Detail Description	Copper Lug, AWG 6#, two hole 3/8", hole spacing 3/4"-1", long barrel, without inspection window

General Specifications

Colour Code	Blue
Material	Copper
Tongue Type	Standard
Tongue Angle	Straight
Surface	Tin-plated
Inspection Window	Without inspection window

Dimensions

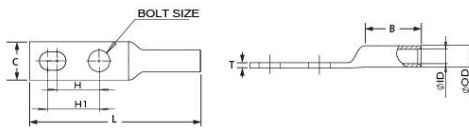

Bolt Size	3/8 in 10.2 mm
Hole Spacing (H)	3/4 in 19.0 mm
Hole Spacing(H1)	1.00 in 25.4 mm
Tang Width (C)	0.60 in 15.5 mm
Barrel length (B)	1.12 in 29.2 mm
Overall length (L)	3.22 in 83.6 mm
Inner diameter (ID)	0.22 in 5.6 mm
Outer diameter (OD)	0.31 in 7.9 mm

Electrical Specifications

Rating - Maximum Voltage	35KV
--------------------------	------

Environmental Specifications

Operating Temperature	-40 °C to +90°C (-40 °F to +212 °F)
-----------------------	-------------------------------------

Storage Temperature	-40 °C to +80 °C (-40 °F to +176 °F)
---------------------	--------------------------------------

Packaging and Weights

Included	Lug
----------	-----

Packaging Quantity and UOM	1 pcs
----------------------------	-------

Piece Weight	0.035 lb 0.016kg
--------------	--------------------

Certifications

ISO 9001:2015	Designed, manufactured and/or distributed under this quality management system
---------------	--

RoHS	Compliant
------	-----------

UL&CSA	Compliant
--------	-----------

