

## Copper Lug, AWG 6#, two hole 3/8", hole spacing 3/4"-1", standard barrel, without inspection window

- Copper cable lugs are designed for connecting copper cables, coils and Bus-bars
- Copper Tube Terminals between 6mm<sup>2</sup> & 800mm<sup>2</sup> have bell entry to ensure easy entry even for flexible conductors.
- The absence without inspection window prevents the entry of water or moisture into the crimped joint making these terminals suitable for outdoor applications.
- The barrel length has been designed to allow easy and accurate positioning of the dies during the crimping operation.
- A hole with elliptical design is suitable for more spacing.



### Product Classification

Material Code	6001501
Detail Description	Copper Lug, AWG 6#, two hole 3/8", hole spacing 3/4"-1", standard barrel, without inspection window

### General Specifications

Material	Copper
Tongue Type	Standard
Tongue Angle	Straight
Surface	Tin-plated
Inspection Window	Without inspection window

### Dimensions

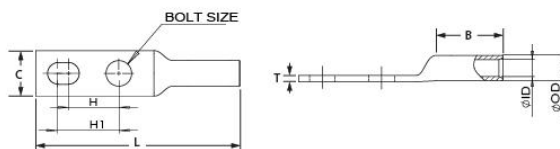

Bolt Size	3/8 in   10.2 mm
Hole Spacing (H)	3/4 in   19.0 mm
Hole Spacing(H1)	1.00 in   25.4 mm
Tang Width (C)	0.57 in   14.6 mm
Barrel length (B)	1.00 in   25.4 mm
Overall length (L)	3.00 in   76.2 mm
Inner diameter (ID)	0.22 in   5.5 mm
Outer diameter (OD)	0.31 in   7.9 mm

### Electrical Specifications

For more information, please visit:  
[www.maxdao.com](http://www.maxdao.com)



©Copyright 2023 Maxdao Inc. All rights reserved.

The information contained herein is subject to change without notice. We reserve the right to make technical changes or modify the contents of this document without prior notice.

Revised: Feb 22, 2023  
 Public

Rating - Maximum Voltage 35KV

---

**Environmental Specifications**

---

Operating Temperature -40 °C to +90°C (-40 °F to +212 °F)

Storage Temperature -40 °C to +80 °C (-40 °F to +176 °F)

---

**Packaging and Weights**

---

Included Lug

Packaging Quantity and UOM 1 pcs

Piece Weight 0.031 lb | 0.014kg

---

**Certifications**

---

ISO 9001:2015 Designed, manufactured and/or distributed under this quality management system

RoHS Compliant

UL&CSA Compliant

