

## Copper Lug, AWG 4#, one hole 5/16", standard belled end barrel, with inspection window

- Copper cable lugs are designed for connecting copper cables, coils and Bus-bars.
- Copper Tube Terminals between 6mm<sup>2</sup> & 800mm<sup>2</sup> have bell entry to ensure easy entry even for flexible conductors.
- Incorporates inspection window to check the correct cable positioning.
- Flared entry prevents bent back strands when inserting fine strand conductor into barrel.



### Product Classification

Material Code	6005612
Detail Description	Copper Lug, AWG 4#, one hole 5/16", standard belled end barrel, with inspection window

### General Specifications

Material	Copper
Tongue Type	Narrow
Tongue Angle	Straight
Surface	Tin-plated
Inspection Window	With inspection window

### Dimensions

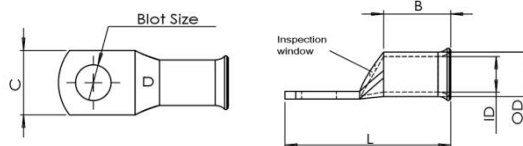

Bolt Size	5/16 in   8.3 mm
Tang Width (C)	0.55 in   14.0 mm
Barrel length (B)	0.71 in   18.0 mm
Overall length (L)	1.54 in   39.0 mm
Inner diameter (ID)	0.28 in   7.1 mm
Outer diameter (OD)	0.37 in   9.5 mm

### Electrical Specifications

Rating - Maximum Voltage	35KV
--------------------------	------

### Environmental Specifications

Operating Temperature	-40 °C to +90°C (-40 °F to +212 °F)
Storage Temperature	-40 °C to +80 °C (-40 °F to +176 °F)

### Packaging and Weights

For more information, please visit:  
[www.maxdao.com](http://www.maxdao.com)



©Copyright 2023 Maxdao Inc. All rights reserved.

The information contained herein is subject to change without notice. We reserve the right to make technical changes or modify the contents of this document without prior notice.

Revised: Mar 14, 2023

Public

Included	Lug
Packaging Quantity and UOM	1 pcs
Piece Weight	0.024 lb   0.011 kg

---

**Certifications and Certificated**

---

ISO 9001:2015	Designed, manufactured and/or distributed under this quality management system
RoHS	Compliant

