

Copper Lug, AWG 4#, one hole 5/16", long barrel, without inspection window

- Copper cable lugs are designed for connecting copper cables, coils and Bus-bars
- Copper Tube Terminals between 6mm² & 800mm² have bell entry to ensure easy entry even for flexible conductors.
- The absence without inspection window prevents the entry of water or moisture into the crimped joint making these terminals suitable for outdoor applications.
- Long barrel provides high pull-out force and increased retention for improved mechanical and electrical performance.



Product Classification

Material Code	6004815
Detail Description	Copper Lug, AWG 4# , one hole 5/16", long barrel, without inspection window

General Specifications

Material	Copper
Tongue Type	Standard
Tongue Angle	Straight
Surface	Tin-plated
Inspection Window	Without inspection window

Dimensions

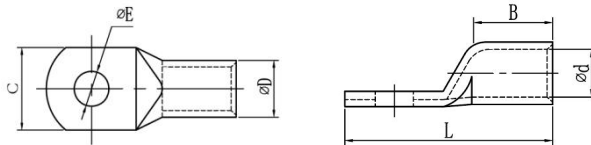

Bolt Size (E)	5/16 in 8.4 mm
Tang Width (C)	0.55 in 15.0 mm
Barrel length (B)	1.12 in 28.5 mm
Overall length (L)	2.28 in 58.0 mm
Inner diameter (d)	0.28 in 7.0 mm
Outer diameter (D)	0.39 in 10.0 mm

Electrical Specifications

Rating - Maximum Voltage	35KV
--------------------------	------

Environmental Specifications

Operating Temperature	-40 °C to +90°C (-40 °F to +212 °F)
Storage Temperature	-40 °C to +80 °C (-40 °F to +176 °F)



Packaging and Weights

Included	Lug
Packaging Quantity and UOM	Kit of 10
Piece Weight	0.035 lb 0.016 kg

Certifications and Certificated

ISO 9001:2015	Designed, manufactured and/or distributed under this quality management system
RoHS	Compliant

