

## Copper Lug, AWG 250KCM, one hole 1/4", standard barrel, with inspection window

- Copper cable lugs are designed for connecting copper cables, coils and Bus-bars.
- Copper Tube Terminals between 6mm<sup>2</sup> & 800mm<sup>2</sup> have bell entry to ensure easy entry even for flexible conductors.
- Incorporates inspection window to check the correct cable positioning.
- "colour code" help choose the right connector, the colour name is also printed in order to avoid problems for those who are colour-blind.
- Narrow tongue design for limited space applications.



### Product Classification

Material Code	6005390
Part Number	-
Detail Description	Copper Lug, AWG 250KCM , one hole 1/4", standard barrel, with inspection window

### General Specifications

Colour Code	Purple
Material	Copper
Tongue Type	Narrow
Tongue Angle	Straight
Surface	Tin-plated
Inspection Window	With inspection window

### Dimensions

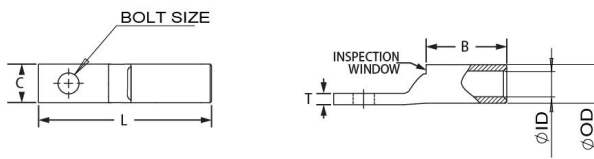

Bolt Size	1/4 in   6.9 mm
Tang Width (C)	0.90 in   23.9 mm
Barrel length (B)	1.06 in   27.0 mm
Overall length (L)	2.22 in   56.6 mm
Inner diameter (ID)	0.63 in   15.9 mm
Outer diameter (OD)	0.77 in   19.6 mm

### Electrical Specifications

Rating - Maximum Voltage	35KV
--------------------------	------

### Environmental Specifications

For more information, please visit:  
www.maxdao.com



©Copyright 2023 Maxdao Inc. All rights reserved.

The information contained herein is subject to change without notice. We reserve the right to make technical changes or modify the contents of this document without prior notice.

Revised: Mar 06, 2023

Public

Operating Temperature -40 °C to +90°C (-40 °F to +212 °F)

Storage Temperature -40 °C to +80 °C (-40 °F to +176 °F)

---

### Packaging and Weights

---

Included	Lug
Packaging Quantity and UOM	1 pcs
Piece Weight	0.101 lb   0.046 kg

---

### Certifications and Certificated

---

ISO 9001:2015	Designed, manufactured and/or distributed under this quality management system
RoHS	Compliant
UL&CSA	Compliant

