

Copper Lug, AWG14-10# two hole 1/4", hole spacing 5/8", long barrel, with inspection window

- Copper cable lugs are designed for connecting copper cables, coils and Bus-bars
- Copper Tube Terminals between 6mm² & 800mm² have bell entry to ensure easy entry even for flexible conductors.
- Incorporates inspection window to check the correct cable positioning
- Long barrel provides high pull-out force and increased retention for improved mechanical and electrical performance.
- "colour code" help choose the right connector, the colour name is also printed in order to avoid problems for those who are colour-blind.



Product Classification

Material Code	6006587
Part Number	-
Detail Description	Copper Lug, AWG14-10# two hole 1/4", hole spacing 5/8", long barrel, with inspection window

General Specifications

Colour Code	Yellow
Material	Copper
Tongue Type	Standard
Tongue Angle	Straight
Surface	Tin-plated
Inspection Window	With inspection window

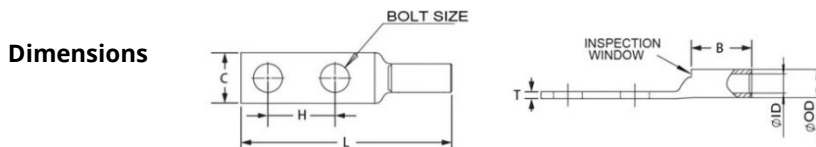

Bolt Size	1/4 in 6.9 mm
Hole Spacing (H)	5/8 in 16.0 mm
Tang Width (C)	0.41 in 12.2 mm
Barrel length (B)	0.69 in 17.8 mm
Overall length (L)	2.16 in 53.4 mm
Inner diameter (ID)	0.13 in 3.4 mm

For more information, please visit:
www.maxdao.com



©Copyright 2023 Maxdao Inc. All rights reserved.
 The information contained herein is subject to change without notice. We reserve the right to make technical changes or modify the contents of this document without prior notice.
 Revised: Feb 22, 2023
 Public

Outer diameter (OD)	0.22 in 5.6 mm
---------------------	------------------

Electrical Specifications

Rating - Maximum Voltage	35KV
--------------------------	------

Environmental Specifications

Operating Temperature	-40 °C to +90°C (-40 °F to +212 °F)
-----------------------	-------------------------------------

Storage Temperature	-40 °C to +80 °C (-40 °F to +176 °F)
---------------------	--------------------------------------

Packaging and Weights

Included	Lug
----------	-----

Packaging Quantity and UOM	1 pcs
----------------------------	-------

Piece Weight	0.015 lb 0.007 kg
--------------	---------------------

Certifications

ISO 9001:2015	Designed, manufactured and/or distributed under this quality management system
---------------	--------------------------------------------------------------------------------

RoHS	Compliant
------	-----------

UL&CSA	Compliant
--------	-----------

