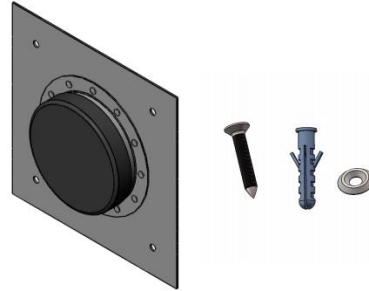

**Cable Entry Panels Feeder Windows Kit,1×1,5 in port with cap**

- Port caps and mounting hardware included
- Quick and easy to install
- Good weatherproof performance

**Product Classification**

Material Number	6001502
Part Number	-
Status	Active
Detail Description	Cable entry panels feeder windows kit,1×1,5 in port with cap,include 1 pcs 5''entry panel and 1 pcs port cap and 4 pcs tapping screw and 4 pcs nylon wall plug and 4 pcs fisheye washer

**General Specifications**

Material	Aluminum entry panel & EPDM port cap & Nylon wall plug & SUS304 fisheye washer and tapping screw
Entry panel port size	127 mm   5 in
Entry panel surface treatment method	Powder coating
Number of ports	1
Panel type	Multiple
Color	Gray & Black

**Dimensions**

Panel size(Length×Width×Height)	241.3 mm×241.3 mm×38mm   9.5 in×9.5 in×1.5 in
Tapping screw size	ST5.5×45 mm  ST0.22 in×1.77 in
Wall plug size	M8×40 mm  M8×1.57 in
Fisheye washer size	M6×18 mm  M8×0.71 in

**Environmental Specifications**

Operating temperature	-40°C to +85°C (-40°F to +185°F)
Waterproof resistance	IP66,based on ISO20653:2013

**Packaging and Weights**

Box length	370 mm   14.57 in
------------	-------------------

For more information, please visit:  
www.maxdao.com



©Copyright 2023 Maxdao Inc. All rights reserved.

The information contained herein is subject to change without notice. We reserve the right to make technical changes or modify the contents of this document without prior notice.

Revised:Mar 14, 2023

Public

Box width	310 mm   12.20 in
Box height	50 mm   1.97 in
Packaging quantity and UOM	1 kit
Included	Entry panel & Hardware kit & Port cap
Weight gross	0.405 kg   0.893 lb

---

**Certifications and Compliance**

---

ISO 9001:2015	Designed, manufactured and/or distributed under this quality management system
RoHS	Compliant

